

# MERIDIAN TOWNHOMES



ARTIST IMPRESSION

SETTE 3S 17SQ  
 \$409,000\* FIXED PRICE  
 \$399,000 FHB PRICE



LOT: 9009 STATURE AVE, CLYDE NORTH  
 BLOCK SIZE: 189m<sup>2</sup>

### INCLUSIONS LIST

- No Body Corporate
- Fixed Price - no hidden extras and no more to pay!
- Front Landscaping.
- Boundary Fencing.
- Rendered Letterbox.
- Coloured Driveway.
- Timberlook Flooring to living rooms. Carpet to bedrooms. Tiles to wet areas.
- Ducted Heating.

Townhomes created by

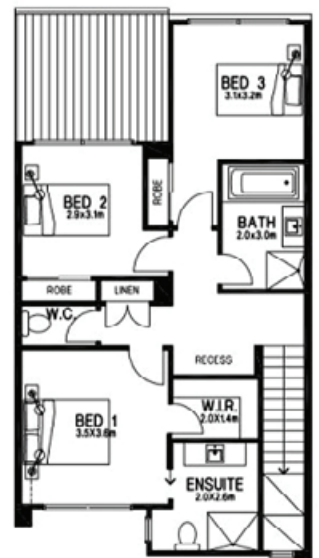
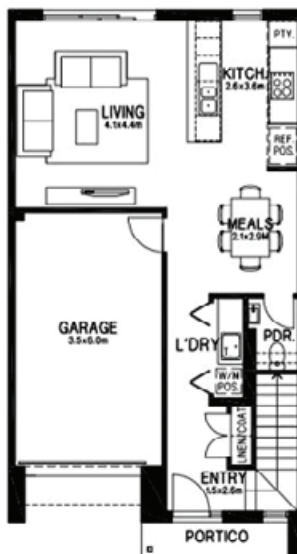

### DEVELOPER

PACKAGE PRICE MAY VARY DUE TO ACTUAL LAND AVAILABILITY. BUILDERS RESERVE THE RIGHT TO CHANGE PRICES WITHOUT NOTICE TO THE DEVELOPER. THE DEVELOPER IS ONLY PROVIDING THE LAND COMPONENT OF THE HOUSE AND LAND PACKAGE. FIXED PRICE PACKAGES ARE SUBJECT TO THE DEVELOPER'S DESIGN REVIEW PANEL'S FINAL APPROVAL. EVERY PRECAUTION HAS BEEN TAKEN TO ESTABLISH THE ACCURACY OF THE MATERIAL HEREIN HOWEVER, PROSPECTIVE BUYERS SHOULD MAKE THEIR OWN ENQUIRIES OF THE BUILDERS DIRECTLY TO SATISFY THEMSELVES ON ALL ASPECTS OF THE HOUSE AND ITS SUITABILITY FOR THE LAND SELECTED. ALL ARTWORK IS ARTIST IMPRESSIONS ONLY AND FINAL PRODUCT MAY DIFFER. THE ADVERTISING PRICING IS ACCURATE AS AT THE TIME OF PRINTING.

### BUILDER

PRICE IS CORRECT AS AT TIME OF PUBLICATION AND IS SUBJECT TO LAND AVAILABILITY AND MAY CHANGE AS A RESULT OF VARIATIONS IN THE INCLUSIONS OR SPECIFICATIONS SELECTED BY THE PURCHASER OR DUE TO OTHER CIRCUMSTANCES THAT MAY AFFECT THE HOUSE AND LAND PACKAGE. FIXED PRICE PACKAGES ARE SUBJECT TO THE DEVELOPER'S DESIGN REVIEW PANEL'S FINAL APPROVAL. PRICE EXCLUDES STAMP DUTY ON LAND, LEGAL FEES AND CONVEYANCING COSTS. PACKAGE PRICE IS BASED ON TOWNLIVING BY METRICON SPECIFICATIONS AND THE ADVERTISED INCLUSION LIST ABOVE. LAND SUPPLIED BY DEVELOPER AND LAND PRICES AND AVAILABILITY ARE SUBJECT TO CHANGE WITHOUT NOTICE. FOR INFORMATION, TERMS AND CONDITIONS ON TOWNLIVING BY METRICON OR FOR A FULL LIST OF DETAILED INCLUSIONS PLEASE SPEAK WITH A SALES CONSULTANT OR VISIT [HTTPS://WWW.METRICON.COM.AU/BUILDERS/MELBOURNE/TOWNLIVING](https://www.metricon.com.au/builders/melbourne/townliving). NEWFIELD REAL ESTATE PTY LTD ACN 159 312 722, LICENCE NUMBER 028051L VIC BUILDERS LICENCE: CDB-U 52967. PACKAGE PRINT DATE 5 MAY 2020.



# MERIDIAN TOWNHOMES



ARTIST IMPRESSION

SETTE 3S 17SQ  
 \$409,000\* FIXED PRICE  
 \$399,000 FHB PRICE



LOT: 9014 STATURE AVE, CLYDE NORTH  
 BLOCK SIZE: 189m<sup>2</sup>

## INCLUSIONS LIST

- No Body Corporate
- Fixed Price - no hidden extras and no more to pay!
- Front Landscaping.
- Boundary Fencing.
- Rendered Letterbox.
- Coloured Driveway.
- Timberlook Flooring to living rooms. Carpet to bedrooms. Tiles to wet areas.
- Ducted Heating.

Townhomes created by

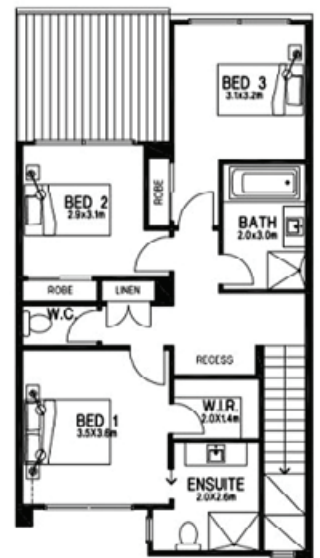
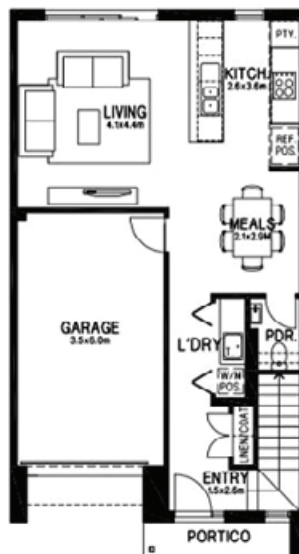

## DEVELOPER

PACKAGE PRICE MAY VARY DUE TO ACTUAL LAND AVAILABILITY. BUILDERS RESERVE THE RIGHT TO CHANGE PRICES WITHOUT NOTICE TO THE DEVELOPER. THE DEVELOPER IS ONLY PROVIDING THE LAND COMPONENT OF THE HOUSE AND LAND PACKAGE. FIXED PRICE PACKAGES ARE SUBJECT TO THE DEVELOPER'S DESIGN REVIEW PANEL'S FINAL APPROVAL. EVERY PRECAUTION HAS BEEN TAKEN TO ESTABLISH THE ACCURACY OF THE MATERIAL HEREIN HOWEVER, PROSPECTIVE BUYERS SHOULD MAKE THEIR OWN ENQUIRIES OF THE BUILDERS DIRECTLY TO SATISFY THEMSELVES ON ALL ASPECTS OF THE HOUSE AND ITS SUITABILITY FOR THE LAND SELECTED. ALL ARTWORK IS ARTIST IMPRESSIONS ONLY AND FINAL PRODUCT MAY DIFFER. THE ADVERTISING PRICING IS ACCURATE AS AT THE TIME OF PRINTING.

## BUILDER

PRICE IS CORRECT AS AT TIME OF PUBLICATION AND IS SUBJECT TO LAND AVAILABILITY AND MAY CHANGE AS A RESULT OF VARIATIONS IN THE INCLUSIONS OR SPECIFICATIONS SELECTED BY THE PURCHASER OR DUE TO OTHER CIRCUMSTANCES THAT MAY AFFECT THE HOUSE AND LAND PACKAGE. FIXED PRICE PACKAGES ARE SUBJECT TO THE DEVELOPER'S DESIGN REVIEW PANEL'S FINAL APPROVAL. PRICE EXCLUDES STAMP DUTY ON LAND, LEGAL FEES AND CONVEYANCING COSTS. PACKAGE PRICE IS BASED ON TOWNLIVING BY METRICON SPECIFICATIONS AND THE ADVERTISED INCLUSION LIST ABOVE. LAND SUPPLIED BY DEVELOPER AND LAND PRICES AND AVAILABILITY ARE SUBJECT TO CHANGE WITHOUT NOTICE. FOR INFORMATION, TERMS AND CONDITIONS ON TOWNLIVING BY METRICON OR FOR A FULL LIST OF DETAILED INCLUSIONS PLEASE SPEAK WITH A SALES CONSULTANT OR VISIT [HTTPS://WWW.METRICON.COM.AU/BUILDERS/MELBOURNE/TOWNLIVING](https://www.metricon.com.au/builders/melbourne/townliving). NEWFIELD REAL ESTATE PTY LTD ACN 159 312 722, LICENCE NUMBER 028051L VIC BUILDERS LICENCE: CDB-U 52967. PACKAGE PRINT DATE 5 MAY 2020.

